

# Solamat 90



## IMPORTANT - READ FIRST

**Only put the machine into operation once you have read and understood the operating instructions. We shall be happy to answer any questions you may have.**

HEUTE Solamat sole cleaning machines are built and tested in accordance with the latest safety regulations. The faultless functionality and operational assurance of the device can only be guaranteed if the generally applicable safety precautions and device-specific safety information in this operating manual are observed during use. The guarantee is not valid in relation to damages caused by a failure to observe this operating manual. The manufacturer assumes no liability for personal injury or damage to property arising as a result of this. In the event of problems please contact our service department immediately.

## Intended use

HEUTE Solamat sole cleaning machines are used to clean the soles of closed shoes and boots by means of electrically driven brushes. No other use is permissible!

Only use the brushes approved for use with the machines by the manufacturer.

Operation is only permissible in closed, dry rooms whilst observing the specifications listed in the "Safety instructions" section.

Use in potentially explosive areas is not permitted.

## Foreseeable erroneous use

The shoe cleaning machine is not suitable for use as follows:

- Cleaning, cleansing and care of human body parts and objects that are not parts of a shoe.
- Use as a tool for working on surface finishes
- Use with the addition of fluids

## Safety instructions



The machine must not be changed or modified because this can lead to risks such as a short circuit, electric shock, fire. Maintenance and repairs must be carried out exclusively by authorised persons with the use of original parts.

The use of non-original replacement parts or the implementation of unauthorised modifications to the machine will result in the declaration of conformity issued by the manufacturer/distributor and the CE sign being voided with immediate effect.

Only use the machine in closed rooms. Direct contact with water must be avoided!

Operation is only permissible at ambient temperatures between 0° C and 40° C.

The product must not be allowed to fall.



Do not continue to use the machine if the cleaning brushes are worn. This can result in damage to the shoe. The brushes must be replaced by a qualified person.



The design complies with protection class I. The voltage supply is 230 V AC, 50 Hz or 115 Volt AC, 50 Hz. **Observe the specific data provided on the manufacturer's type plate!**



During use, the motor can heat up to temperatures of up to 90° C. Do not touch the motor without wearing safety gloves.



Use by children, in particular when unattended, must be excluded.

Ensure that any contact between (household) animals and the machine is excluded.

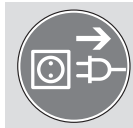

Always disconnect the mains power plug prior to service and repair work.

Do not continue to use the machine if it is damaged and disconnect the mains power plug.



Excessive application pressure during use of the brush can lead to damage to shoes/boots!

The operator is responsible for all personal injury and damage to property that arises due to unintended use, faulty machine connections and/or operating errors.

Prior to cleaning, always unplug the mains power plug and disconnect the power supply.

When cleaning the housing use of a dry or damp microfibre cloth is recommended.

Do not use cleaning products or household cleaner.

Protect the machine against moisture, spray water and the effects of heat.

When in commercial establishments observe the safety ordinance applicable on site as well as the accident prevention regulations issued by the union of professional associations for electrical systems and equipment.

Ensure that the installation is level.

## Welcome

Dear Customer, we would like to thank you for purchasing one of our HEUTE industrial sole cleaning machines.

This operating manual is a constituent of the machine. It contains important information on commissioning, operation and maintenance. Please store this operating manual for future reference!

## Scope of supply

Machine, power cable, operating manual

## Declaration of Conformity

The manufacturer herewith confirms that the following machine of type Solamat 90 complies with the directives listed below:

EC Machinery Directive (2006/42/EC)

EC EMC Directive (2004/108/EC)

### Technical specifications

- DIN EN 60335-1 (DIN VDE 0700-1):2012-10
- DIN EN 60335-2-82 (DIN VDE 0700-82):2009-02
- DIN EN 55014-1 (DIN VDE 0875-14-1):2012-05
- DIN EN 55014-2 (DIN VDE 0875-14-2):2009-06
- DIN EN 61000-3-2 (DIN VDE 0838-2):2011-06
- DIN 61000-3-3 (DIN VDE 0838-3):2009-06
- DIN 61000-6-2 (DIN VDE 0839-6-2):2011-06
- DIN 61000-6-3 (DIN VDE 0839-6-3):2012-11

Authorized representative Steffen Moersch.

Contact details (see address of manufacturer).



Christian Löwe, Managing Director  
Maschinenfabrik HEUTE GmbH & Co. KG

## Environmental protection

### Disposal of transport packaging

The packaging materials in which your machine is supplied are environmentally friendly and recyclable. Please help by disposing of the packaging in an environmentally friendly manner. The packaging must not be given to children to play with. There is a risk of suffocation due to the folding box and film.

### Disposal of the product

Old devices that are no longer in use are not worthless waste. Valuable raw materials can be recovered through environmentally friendly disposal. Please inform yourself of the current disposal methods by contacting the person responsible within your company or your local authority.

## Table of contents

<b>Important – read first</b>	<b>14</b>
<b>Intended use</b>	<b>14</b>
<b>Foreseeable erroneous use</b>	<b>14</b>
<b>Safety instructions</b>	<b>14</b>
<b>Welcome</b>	<b>15</b>
<b>Scope of supply</b>	<b>15</b>
<b>Declaration of Conformity</b>	<b>15</b>
<b>Environmental protection</b>	<b>14</b>
<b>Commissioning</b>	<b>16</b>
Erection	<b>16</b>
Electrical connection	<b>16</b>
<b>Operation</b>	<b>16</b>
Switching on and off	<b>16</b>
Sole cleaning	<b>16</b>
<b>Cleaning and care of the machine</b>	<b>16</b>
Cleaning the housing	<b>16</b>
Coarse dirt drawer	<b>16</b>
<b>Regular maintenance</b>	<b>16</b>
<b>Service and repairs</b>	<b>16</b>
Disassembling the motor mounting	<b>16</b>
Changing the roller brushes – Solamat 90	<b>17</b>
Changing the disc brushes – Solamat 90	<b>18</b>
Belt change – SOLAMAT 90	<b>19</b>
<b>Trouble-shooting</b>	<b>20</b>
<b>Technical data</b>	<b>21</b>
<b>Wiring diagram</b>	<b>19</b>
<b>Parts drawing – Solamat 90</b>	<b>22</b>

## Commissioning

### Erection

The erection site must be covered. The machine must be erected such that it is level and will not slip. It must also be protected against water spray and the effects of water. In order to guarantee that the machine is stable, level out any uneven floor areas, e.g. by shimming with suitable rubber strips.

### Electrical connection

The machine is delivered ready for mains connection with a power cable. Connection to the mains power supply must be established via a standardised, fused and earthed socket. Voltage and current must concur with the data on the type plate (110 Volt or 230 Volt).

## Operation

### Switching on and off

The machine is started up via a foot sensor switch and is switched off automatically after approx. 40 seconds via a time relay unless the foot sensor switch is actuated once more.

### Shoe and boot cleaning

When using ensure that you have established a stable position in front of the machine and that you will not slip. The closed shoes/boots that require cleaning must be cleaned on the machine exclusively whilst on the foot of the user. It is prohibited to use the machine when laces are untied or other loose parts are on the shoe. This can result in damage to the machine and shoe, and may also lead to serious injuries.



**Caution - risk of injury!**

The dirty soles and sole edges can be cleaned on the coarse nylon brushes by lightly pressing the soles of the shoes against the brushes. Moving the soles back and forth, up and down on the brushes results in dry dirt being removed and this is transferred to the dirt trap beneath the brushes.

### Leather upper cleaning (SOLAMAT 100/200)

The shoe requiring cleaning is pressed lightly against the upper roller brush. Turning the shoe to the side also allows the user to clean the sides of the shoes.

## Cleaning and care of the machine

### Cleaning the housing

Prior to cleaning always unplug the mains power plug and in doing so disconnect the power supply. When cleaning the housing we recommend use of a dry or damp microfibre cloth. Dirt that has dried onto the steps must be removed with a brush as necessary. Do not use cleaning products or household cleaner.

### Coarse dirt drawer

Coarse dirt that has been cleaned off is trapped in the drawer beneath the brushes. The drawer must be emptied regularly.

## Regular maintenance

- ▶ Empty the dirt drawer regularly.
- ▶ Check belt tension: The brushes must move when the belt is moved in the direction of rotation without slippage. A round belt that is too loose can slip due to loading by the drive pulley and this may lead to damage.
- ▶ Replace any damaged, worn or excessively loose round belts (see chapter **Service and repairs** > *Belt change*). Motor maintenance is not necessary.
- ▶ Replace any damaged or worn brushes (see chapter **Service and repairs** > *Brush change*). The flange bearing should be replaced during a brush change.
- ▶ Check the filter mat (only SOLAMAT 200) and replace if necessary (see chapter **Service and repairs** > *Filter change SOLAMAT 200*)

## Service and repairs

All electrical repairs must be carried out by customer service technicians and electricians exclusively. Unplug the mains power plug prior to all repair works on the machine!

When ordering spare parts please provide the following information:

- ▶ Machine number
- ▶ Year of manufacture

You can find the type plate bearing this information on the back of the housing.

### Disassembling the motor mounting

In order to gain better access to the brushes, round belts or flange bearings it may be necessary to disassemble the motor mounting as follows.

- 1.** Interrupt the power supply by disconnecting the mains plug.
- 2.** Remove the dirt drawer.
- 3.** Remove the 6 hexagon socket screws (width across flats 3 mm) visible from above (see Fig. 1).
- 4.** Turn the machine upside down and place it on a suitable work surface such that it is lying on the top of the housing (see Fig. 2).
- 5.** Remove the 2 hexagon socket screws (width across flats 3 mm) on the front and back of the housing respectively, so that the motor mounting is released from the housing (see Fig. 1 and Fig. 2).
- 6.** Detach the cables: 3 earth cables, 2 mains cables (blue mains cable = N conductor, brown mains cable = L conductor). To do so cut through the cable ties with wire cutters (see Fig. 3).
- 7.** Take the motor mounting out of the housing. Observe the cables left in the housing (see Fig. 4).

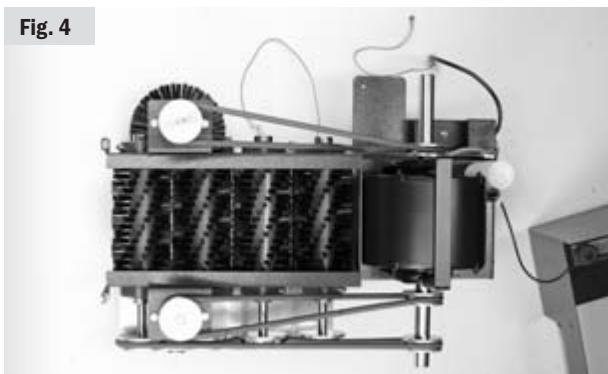

## Changing the roller brushes - Solamat 90

1. Remove round belt no. 2 (size 930V) (see Fig. 5).
2. Release the bearing rings next to both shaft flange bearings (hexagon socket screw, width across flats 2.5 mm) (see Fig. 6).
3. Release hexagon socket screws (width across flats 3 mm) in the brush core (2 per brush).
4. Draw the shaft out of the side of the brush (see Fig. 7).
5. Take the loose roller brush out of the motor mounting.
6. Insert new roller brush and slide in the shaft from the side once more. Prior to inserting the shaft debur it if necessary.
7. Fasten the roller brush to the shaft once again using 2 hexagon socket screws in the brush core. Secure the shaft using the bearing rings next to both flange bearings.
8. Installation of the motor mounting takes place in reverse order to the deinstallation.
9. Check to ensure electrical safety following installation.



### Changing the disc brushes – Solamat 90

1. Disassemble the motor mounting (see chapter **Service and repairs** > *Disassembling the motor mounting*).
2. Remove round belt no. 1 (710 V) and no. 3 (700 V) (see chapter **Service and repairs** > *Belt change - Solamat 90*). Prior to removing the belts, mark these to ensure that they cannot be confused during installation.
3. Set the motor mounting to the side.
4. Loosen the self-locking nuts, which clamp the disc brush onto the shaft. In order to do so it is necessary to secure the axle with a fitting pin to prevent it from rotating (see Fig. 9).
5. Release the 2 bearing rings (hexagon socket screw, width across flats 2.5 mm) (see Fig. 10).
6. Turn out the axle until the brush is free and can be removed.
7. Carry out installation of the new brushes in reverse order. The disc brushes must have 1-2 mm play to the screw heads (see Fig. 11). They must be secured on the shaft once more using new self-locking M10 nuts.
8. Installation of the motor mounting takes place in reverse order to the deinstallation (see chapter **Service and repairs** > *Disassembling the motor mounting*).
9. Check to ensure electrical safety following installation.

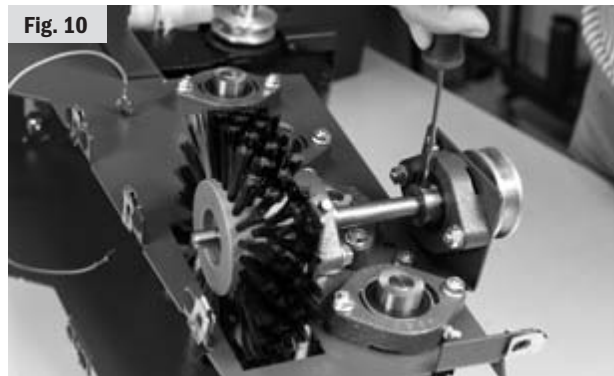

## Belt change - SOLAMAT 90

Round belt no. 1, size 710V, Art. no. 0080085

Round belt no. 2, size 930V, Art. no. 0080070

Round belt no. 3, size 700V, Art. no. 0080080

1. Interrupt the power supply by disconnecting the mains plug.
2. Remove the dirt drawer.
3. Turn the machine upside down and place it on a suitable work surface such that it is lying on the top of the housing with the underside is freely accessible.
4. Remove damaged or worn round belts.

 **Caution - risk of crushing when tensioning the round belt on the belt pulley!**

5. First lay round belt no. 1 on belt pulley 1a. Then lever onto belt pulley 1b using a suitable tool (e.g. screwdriver). When doing so observe the direction of rotation of the belt pulley (see Fig. 14).
6. Lay round belt no. 2 on belt pulley 2a, b, c, d and lever onto belt pulley 2e (see Fig. 15).
7. First lay round belt no. 3 on belt pulley 3a. Then lever onto belt pulley 3b using a suitable tool (e.g. screwdriver) (see Fig. 16).
8. Set the machine back in its upright position and slide the dirt drawer back in.

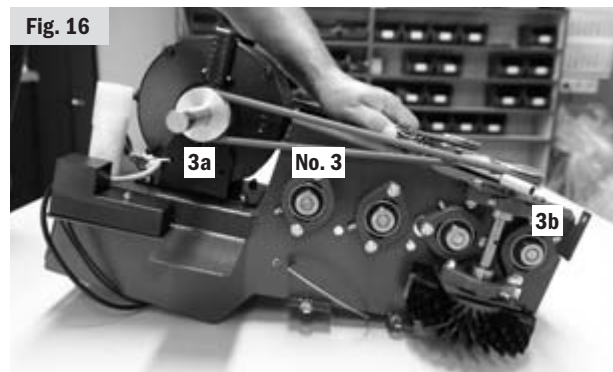
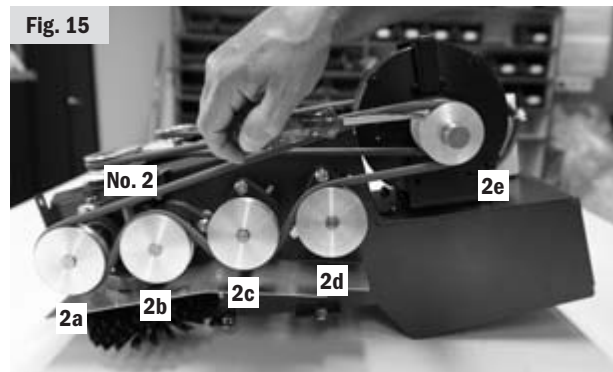
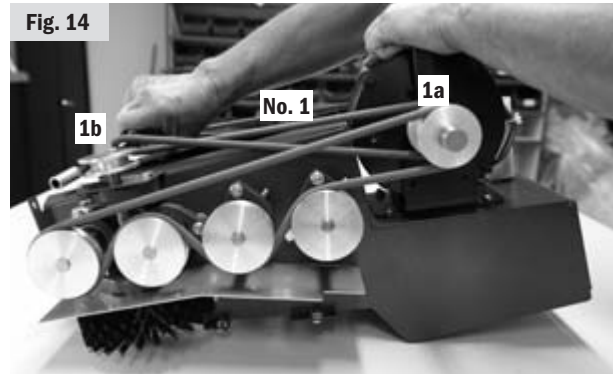



## Trouble-shooting

### ? Machine does not run

- ! Machine has no power supply
- ✓ Check mains power cable (see chapter **Service and repairs** > *Belt change*; in conjunction with Fig. 3)

### ? Roller and / or disc brushes do not rotate constantly

- ! Round belt tension loss  
or
- ! Round belt without guide  
or
- ! Round belt torn
- ✓ Check round belt guide and tension or replace round belt.

### ? Roller and / or disc brushes spin during use

- ! Round belts slip  
or
- ! Roller / disc brushes not fixed on shaft.
- ✓ Fix roller / disc brushes on the shaft with screws.

### ? Motor blocked/running unevenly

- ! poss. foreign objects wound into brushes
- ✓ Unplug the mains power plug immediately and turn the brushes by hand in order to remove any objects that have become wound in

### ? Machine becomes very loud during the cleaning process

- ! Bearing faulty
- ✓ Check bearing and replace if necessary

### ? Fine dust is not sucked off (only Solamat 200)

- ! Filter is blocked
- ✓ Change the filter

## Technical Data

### Solamat 90\*

Dimensions: 460 x 560 x 114 mm (W x D x H)

Weight: 47 kg

Connection values: 230 Volt (110 Volt optional)

Power: 180 Watt, 750 rpm

## Wiring diagram

### Solamat 90/100

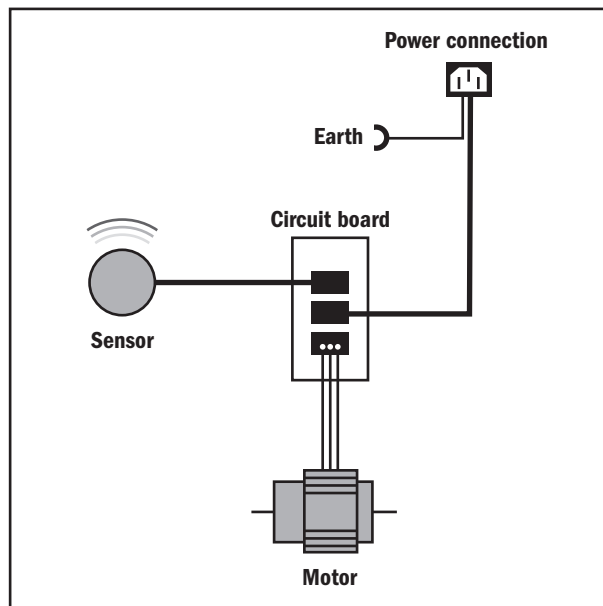

EN

# Solamat 90 parts drawings

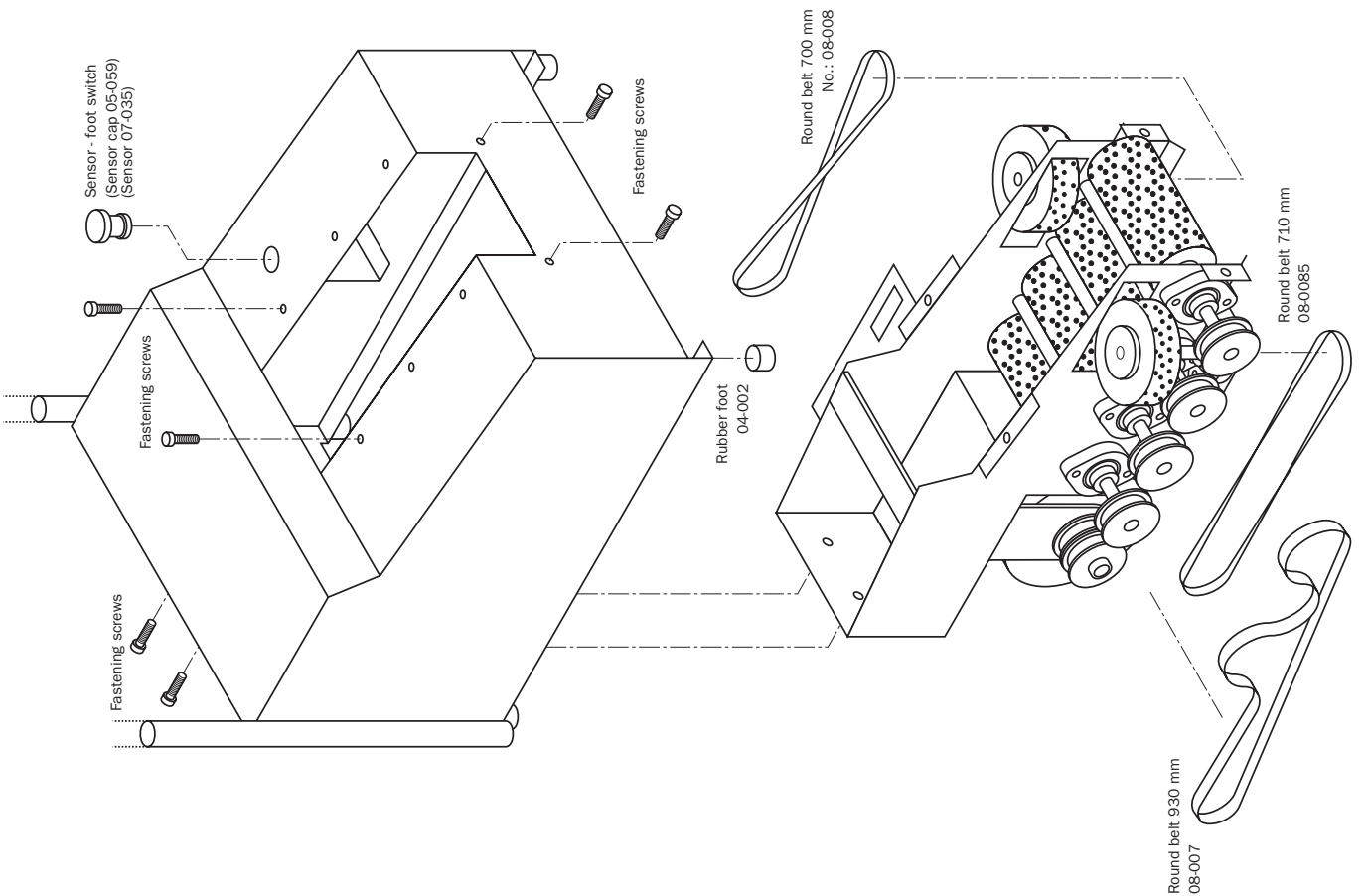
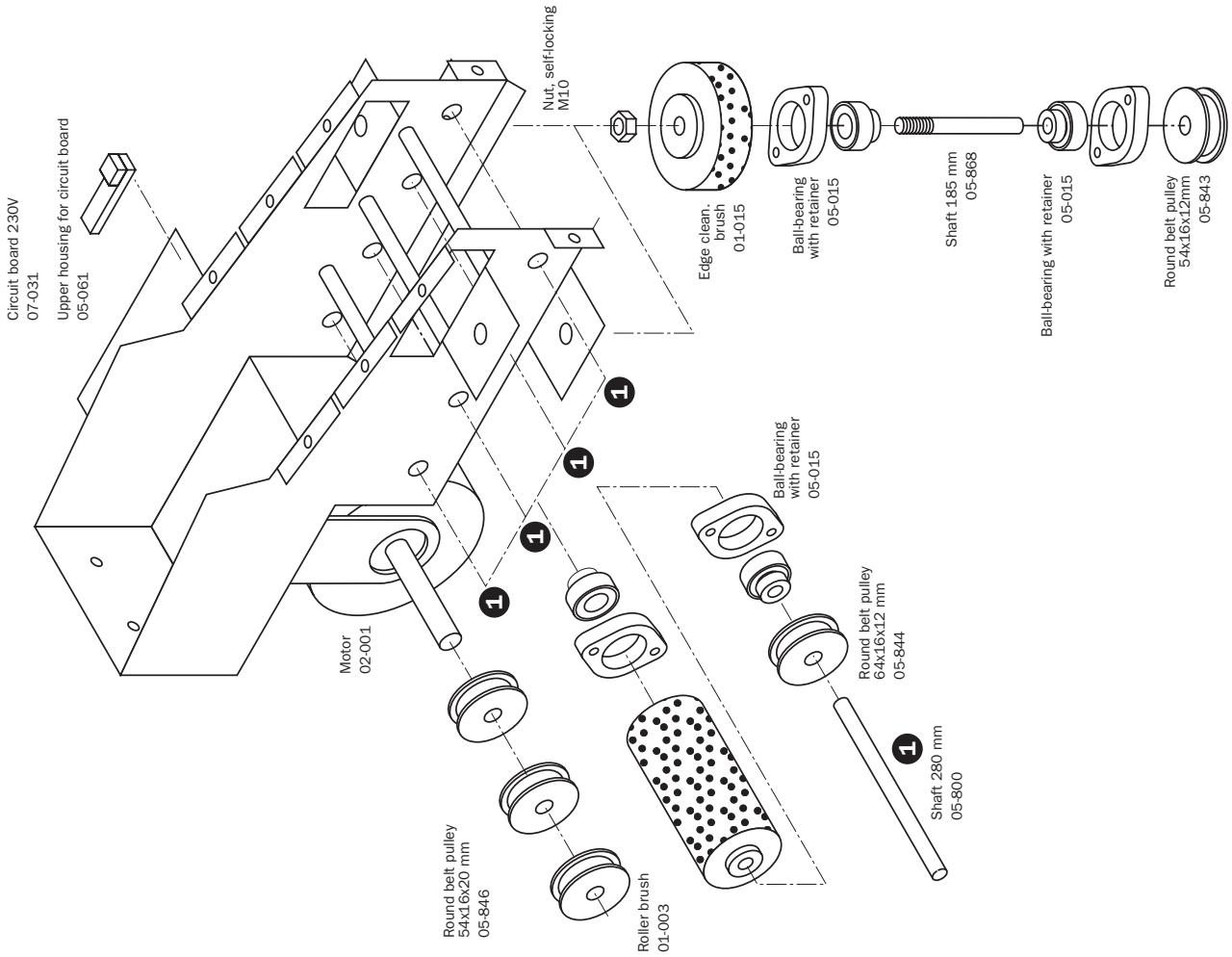



**FMCG Industry Solutions Pty Ltd**

ABN 22 135 446 007

📍 Factory 11A, 1 - 3 Endeavour Rd, Caringbah NSW 2229

🌐 [www.fmcgis.com.au](http://www.fmcgis.com.au)

✉ [sales@fmcgis.com.au](mailto:sales@fmcgis.com.au)

☎ 1300 628 104 or 02 9540 2288